

# SUBLINE700U

**BLANCO**



**Model Code**  
SUBLINE700U

**Description**  
Single bowl undermount with overflow

**Accessories**  
Optional Accessories:  
SUBLINEBK  
SUBLINECOLSS

**Warranty**  
30 year warranty



## Features

## Benefits

Engineered in Germany

Elegant SILGRANIT™ design impresses with its timeless, straight lined bowl geometry which will suit all types of kitchen products and worktops.

Durability

SILGRANIT™ PuraDur™ II consists of 80% granite, which makes it unbeatably resilient, extremely durable, scratch resistant, heat resistant, unbreakable and acid resistant.

Hygiene + Plus™

A patented formula that acts as a shield against dirt and bacteria. This hygiene protection reduces bacteria growth by an average of 98%.

Maximum Bowl Size

Due to the smallest possible radii of 10mm it allows for a large sink area and a modern classy look.

Designer wastes

No additional costs after purchase

Rear waste position

Increases your storage space below the sink



Acid resistant.

Non fading.

Heat resistant.

Stain resistant.

Scratch resistant.

Easy to clean.

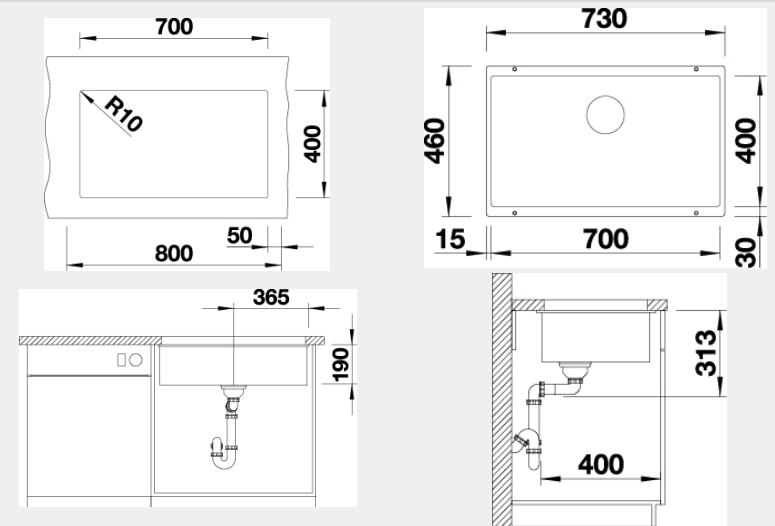

Method of Installation:	Undermount
Overall Dimensions:	730w x 460d x 190hmm
Cut-out Dimensions:	700w x 400d
Colour:	Available in Anthracite
Corner Radius:	10mm
Bowl Capacity:	53 Litres
Standard Inclusion:	Designer Waste
Integrated Overflow:	Yes
Warranty:	30 years

Note: Measurements are within 2/3mm of factory tolerance. It is advisable to check dimensions of physical product when measuring for installations and before doing any cut outs.

\*Due to continual product development the information provided is not final and may be subject to change.